

# INVERELL ART PRIZE SECTIONS *explained...*

The best way to measure your artwork, is with a flexible dressmakers or builders tape measure. Any other enquires please contact the Inverell Art Gallery.

If unsure please ask the Inverell Art Gallery volunteers or manager for a guide as to which section your artwork may be submitted to. We are always willing to help.

You can contact the Inverell Art Gallery on 02 6722 4983 or email [info@inverellartgallery.com.au](mailto:info@inverellartgallery.com.au)

## SECTION 1. OPEN ART

### Conditions of entry:

Must conform to size regulations. Lesser but no greater than 185cm x 125cm ,620cm total perimeter. See right, **example size only**

Open to any subject, medium, format eg, portrait or landscape

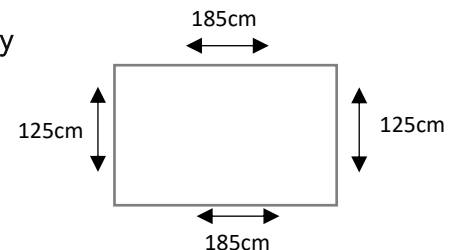

## SECTION 2. LOCAL ART

### Conditions of entry:

Must live within the Inverell Shire Boundaries.

Must conform to size regulations lesser but no greater than 185cm x 125cm =620 total perimeter.

See above right (example only)

2D or 3D entries can be any subject, medium, material, or format eg portrait or landscape,

## SECTION 3. SPECIAL FEATURE "A SMALL MATTER"

### Conditions of entry:

Must conform to "A Small Matter" 2D or 3D size regulations. See below, **example size only**

"A Small Matter" 2D artwork not to exceed 25cm+25cm+25cm+25cm =100cm total perimeter see below. (Example only). Another size example could be 10cm+40cm+10cm+40cm=100cm

Do not include the frame in the measurement.

Any Subject, material, format eg landscape, portrait, abstract, watercolour, acrylic, oil, charcoal etc

"A Small Matter" 3D not to exceed 10cm on any face of object. Must be able to stand horizontally (independently). Can be any subject medium, material, or format.

**2D**

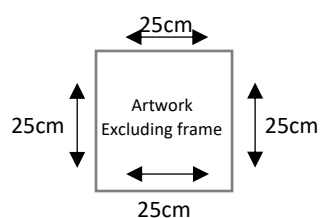

**3D**

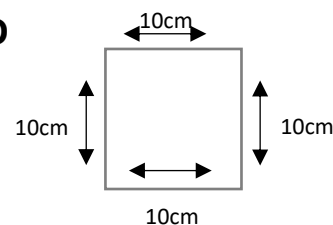

## SECTION 4. 3D or 3 Dimensional

### Conditions of entry:

Must conform to size regulations no greater than 185cm x 125cm =620cm total perimeter. We understand that some items may be hard to measure. Entries will be at the discrepancy of the Inverell Art Society and Gallery Manager. Any subject, medium, material. *Continued...*

3D Artworks explained: 3D that have depth as well as height and width and that exist in space are three-dimensional. This category includes **sculpture, craft and folk art, architecture, and other mixed media art**. May be but not committed to metalwork, woodwork, glass, ceramics, textiles, mosaic, textiles & fibre.

## SECTION 5. APPLIED ARTS

### Conditions of Entry:

Must conform to size regulations. Lesser but no greater than 185cm x 125cm =620cm total perimeter. Any subject, material, medium. The mediums suggested on the entry form are guides only. Can be, but not committed to metal, wood, glass, stained glass, ceramics, textiles, mosaic, textiles & fibre.

### *Applied Artworks explained:*

Taken from Wikipedia "Applied art" in *The Oxford Dictionary of Art*. Online edition. [Oxford University Press](https://www.oxfordreference.com), 2004. [www.oxfordreference.com](https://www.oxfordreference.com). Retrieved 23 November 2013.

The **applied arts** are all the arts that apply design and decoration to everyday and essentially practical objects in order to make them aesthetically pleasing. The term is used in distinction to the fine arts, which are those that produce objects with no practical use, whose only purpose is to be beautiful or stimulate the intellect in some way. In practice, the two often overlap. Applied arts largely overlaps with decorative arts, and the modern making of applied art is usually called design. Example of applied arts are:

- Industrial design - mass-produced objects.
- Architecture - also counted as a fine art.
- Ceramic art
- Fashion design
- Calligraphy
- Interior design
- Graphic design

## SECTION 6. PHOTOGRAPHY

### Conditions of entry:

Must conform to size regulations. **Including frame**, work not to exceed 200cm perimeter, for example see below (example only). Format can be portrait or landscape.

Not to exceed 200cm around the perimeter of whole item. Any subject, medium that is pertaining to a photograph.

### Photograph including frame

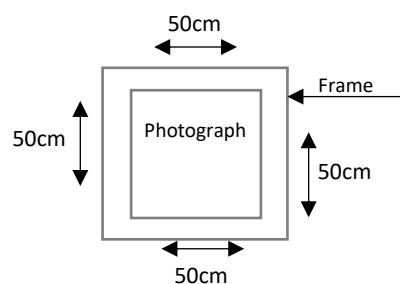

## SECTION 7. YOUNG ARTIST

### Conditions of entry:

Must conform to size regulations no greater than 185cm x 125cm =620cm total perimeter.

Young Artist 12 to 18 years as at the 15<sup>th</sup> October 2021.

Any subject, medium, material.

INVERELL ART GALLERY

5 Evans Street, PO Box 329, Inverell NSW 2360

02 67224983 [www.inverellartgallery.com.au](http://www.inverellartgallery.com.au) www.inverellartgallery.com.au